

DKJ 74° - штуцер, конус 74°, дюймовая UNF резьба.

Артикул штуцера	РУКАВ			ГАЙКА		
	DN	Дюймы	размер	D в мм	Резьба (D)	Ключ (SW)
5 DKJ 7/16"	5	3/16"	03	10,0	7/16" - 20	15
5 DKJ 1/2"	5	3/16"	03	11,6	1/2" - 20	17
6 DKJ 7/16"	6	1/4"	04	10,0	7/16" - 20	15
6 DKJ 1/2"	6	1/4"	04	11,6	1/2" - 20	17
6 DKJ 9/16"	6	1/4"	04	13,0	9/16" - 18	19
8 DKJ 1/2"	8	5/16"	05	11,6	1/2" - 20	17
8 DKJ 9/16"	8	5/16"	05	13,0	9/16" - 18	19
8 DKJ 5/8"	8	5/16"	05	14,7	5/8" - 18	22
8 DKJ 3/4"	8	5/16"	05	17,6	3/4" - 16	24
10 DKJ 9/16"	10	3/8"	06	13,0	9/16" - 18	19
10 DKJ 5/8"	10	3/8"	06	14,7	5/8" - 18	22
10 DKJ 3/4"	10	3/8"	06	17,6	3/4" - 16	24
10 DKJ 7/8"	10	3/8"	06	20,5	7/8" - 14	27
12 DKJ 3/4"	12	1/2"	08	17,6	3/4" - 16	24
12 DKJ 7/8"	12	1/2"	08	20,5	7/8" - 14	27
12 DKJ 1.1/16"	12	1/2"	08	25,0	1.1/16" - 12	32
16 DKJ 7/8"	16	5/8"	10	20,5	7/8" - 14	27
16 DKJ 1.1/16"	16	5/8"	10	25,0	1.1/16" - 12	32
20 DKJ 1.1/16"	20	3/4"	12	25,0	1.1/16" - 12	32
20 DKJ 1.3/16"	20	3/4"	12	27,5	1.3/16" - 12	36
20 DKJ 1.5/16"	20	3/4"	12	31,3	1.5/16" - 12	41
25 DKJ 1.1/16"	25	1"	16	25,0	1.1/16" - 12	32
25 DKJ 1.5/16"	25	1"	16	31,3	1.5/16" - 12	41
25 DKJ 1.5/8"	25	1"	16	39,2	1.5/8" - 12	50
32 DKJ 1.5/8"	32	1.1/4"	20	39,2	1.5/8" - 12	50
32 DKJ 1.7/8"	32	1.1/4"	20	45,6	1.7/8" - 12	55
40 DKJ 1.7/8"	40	1.1/2"	24	45,6	1.7/8" - 12	55
50 DKJ 2.1/2"	50	2"	32	61,5	2.1/2" - 12	70

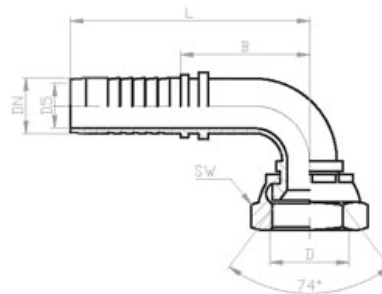

DKJ 74° - 90° - угловой штуцер, конус 74°, дюймовая UNF резьба.

Артикул штуцера	РУКАВ			ГАЙКА		
	DN	Дюймы	размер	D в мм	Резьба (D)	Ключ (SW)
5-90 DKJ 7/16"	5	3/16"	03	10,0	7/16" - 20	15
5-90 DKJ 1/2"	5	3/16"	03	11,6	1/2" - 20	17
6-90 DKJ 7/16"	6	1/4"	04	10,0	7/16" - 20	15
6-90 DKJ 1/2"	6	1/4"	04	11,6	1/2" - 20	17
6-90 DKJ 9/16"	6	1/4"	04	13,0	9/16" - 18	19
8-90 DKJ 1/2"	8	5/16"	05	11,6	1/2" - 20	17
8-90 DKJ 9/16"	8	5/16"	05	13,0	9/16" - 18	19
8-90 DKJ 5/8"	8	5/16"	05	14,7	5/8" - 18	22
8-90 DKJ 3/4"	8	5/16"	05	17,6	3/4" - 16	24
10-90 DKJ 9/16"	10	3/8"	06	13,0	9/16" - 18	19
10-90 DKJ 5/8"	10	3/8"	06	14,7	5/8" - 18	22
10-90 DKJ 3/4"	10	3/8"	06	17,6	3/4" - 16	24
10-90 DKJ 7/8"	10	3/8"	06	20,5	7/8" - 14	27
12-90 DKJ 3/4"	12	1/2"	08	17,6	3/4" - 16	24
12-90 DKJ 7/8"	12	1/2"	08	20,5	7/8" - 14	27
12-90 DKJ 1.1/16"	12	1/2"	08	25,0	1.1/16" - 12	32
16-90 DKJ 7/8"	16	5/8"	10	20,5	7/8" - 14	27
16-90 DKJ 1.1/16"	16	5/8"	10	25,0	1.1/16" - 12	32
20-90 DKJ 1.1/16"	20	3/4"	12	25,0	1.1/16" - 12	32
20-90 DKJ 1.3/16"	20	3/4"	12	27,5	1.3/16" - 12	36
20-90 DKJ 1.5/16"	20	3/4"	12	31,3	1.5/16" - 12	41
25-90 DKJ 1.1/16"	25	1"	16	25,0	1.1/16" - 12	32
25-90 DKJ 1.5/16"	25	1"	16	31,3	1.5/16" - 12	41
25-90 DKJ 1.5/8"	25	1"	16	39,2	1.5/8" - 12	50
32-90 DKJ 1.5/8"	32	1.1/4"	20	39,2	1.5/8" - 12	50
32-90 DKJ 1.7/8"	32	1.1/4"	20	45,6	1.7/8" - 12	55
40-90 DKJ 1.7/8"	40	1.1/2"	24	45,6	1.7/8" - 12	55
50-90 DKJ 2.1/2"	50	2"	32	61,5	2.1/2" - 12	70

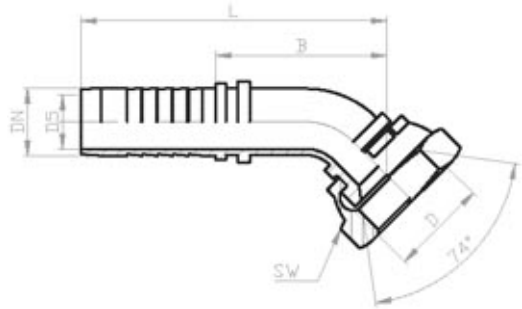

DKJ 74° - 45° - угловой штуцер, конус 74°, дюймовая UNF резьба.

Артикул штуцера	РУКАВ			ГАЙКА		
	DN	Дюймы	размер	D в мм	Резьба (D)	Ключ (SW)
5-45 DKJ 7/16"	5	3/16"	03	10,0	7/16" - 20	15
5-45 DKJ 1/2"	5	3/16"	03	11,6	1/2" - 20	17
6-45 DKJ 7/16"	6	1/4"	04	10,0	7/16" - 20	15
6-45 DKJ 1/2"	6	1/4"	04	11,6	1/2" - 20	17
6-45 DKJ 9/16"	6	1/4"	04	13,0	9/16" - 18	19
8-45 DKJ 1/2"	8	5/16"	05	11,6	1/2" - 20	17
8-45 DKJ 9/16"	8	5/16"	05	13,0	9/16" - 18	19
8-45 DKJ 5/8"	8	5/16"	05	14,7	5/8" - 18	22
8-45 DKJ 3/4"	8	5/16"	05	17,6	3/4" - 16	24
10-45 DKJ 9/16"	10	3/8"	06	13,0	9/16" - 18	19
10-45 DKJ 5/8"	10	3/8"	06	14,7	5/8" - 18	22
10-45 DKJ 3/4"	10	3/8"	06	17,6	3/4" - 16	24
10-45 DKJ 7/8"	10	3/8"	06	20,5	7/8" - 14	27
12-45 DKJ 3/4"	12	1/2"	08	17,6	3/4" - 16	24
12-45 DKJ 7/8"	12	1/2"	08	20,5	7/8" - 14	27
12-45 DKJ 1.1/16"	12	1/2"	08	25,0	1.1/16" - 12	32
16-45 DKJ 7/8"	16	5/8"	10	20,5	7/8" - 14	27
16-45 DKJ 1.1/16"	16	5/8"	10	25,0	1.1/16" - 12	32
20-45 DKJ 1.1/16"	20	3/4"	12	25,0	1.1/16" - 12	32
20-45 DKJ 1.3/16"	20	3/4"	12	27,5	1.3/16" - 12	36
20-45 DKJ 1.5/16"	20	3/4"	12	31,3	1.5/16" - 12	41
25-45 DKJ 1.1/16"	25	1"	16	25,0	1.1/16" - 12	32
25-45 DKJ 1.5/16"	25	1"	16	31,3	1.5/16" - 12	41
25-45 DKJ 1.5/8"	25	1"	16	39,2	1.5/8" - 12	50
32-45 DKJ 1.5/8"	32	1.1/4"	20	39,2	1.5/8" - 12	50
32-45 DKJ 1.7/8"	32	1.1/4"	20	45,6	1.7/8" - 12	55
40-45 DKJ 1.7/8"	40	1.1/2"	24	45,6	1.7/8" - 12	55
50-45 DKJ 2.1/2"	50	2"	32	61,5	2.1/2" - 12	70

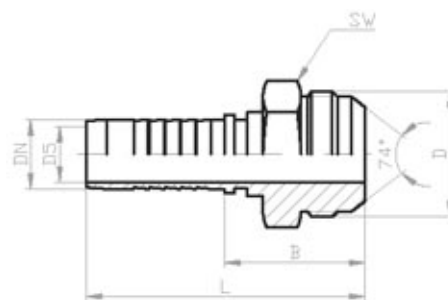

AGJ 74° - штуцер (нипель), конус 74°, дюймовая UNF резьба.

Артикул штуцера	РУКАВ			НИППЕЛЬ		
	DN	Дюймы	размер	D в мм	Резьба (D)	Ключ (SW)
5 DKJ 7/16"	5	3/16"	03	11,07	7/16" - 20	12
5 DKJ 1/2"	5	3/16"	03	12,70	1/2" - 20	14
6 DKJ 7/16"	6	1/4"	04	11,07	7/16" - 20	12
6 DKJ 1/2"	6	1/4"	04	12,70	1/2" - 20	14
6 DKJ 9/16"	6	1/4"	04	14,25	9/16" - 18	15
8 DKJ 1/2"	8	5/16"	05	12,70	1/2" - 20	14
8 DKJ 9/16"	8	5/16"	05	14,25	9/16" - 18	15
8 DKJ 5/8"	8	5/16"	05	15,85	5/8" - 18	17
8 DKJ 3/4"	8	5/16"	05	19,00	3/4" - 16	19
10 DKJ 9/16"	10	3/8"	06	14,25	9/16" - 18	15
10 DKJ 5/8"	10	3/8"	06	15,85	5/8" - 18	17
10 DKJ 3/4"	10	3/8"	06	19,00	3/4" - 16	19
10 DKJ 7/8"	10	3/8"	06	22,17	7/8" - 14	24
12 DKJ 3/4"	12	1/2"	08	19,00	3/4" - 16	19
12 DKJ 7/8"	12	1/2"	08	22,17	7/8" - 14	24
12 DKJ 1.1/16"	12	1/2"	08	26,95	1.1/16" - 12	27
16 DKJ 7/8"	16	5/8"	10	22,17	7/8" - 14	24
16 DKJ 1.1/16"	16	5/8"	10	26,95	1.1/16" - 12	27
20 DKJ 1.1/16"	20	3/4"	12	26,95	1.1/16" - 12	27
20 DKJ 1.3/16"	20	3/4"	12	30,10	1.3/16" - 12	32
20 DKJ 1.5/16"	20	3/4"	12	33,30	1.5/16" - 12	34
25 DKJ 1.1/16"	25	1"	16	26,95	1.1/16" - 12	27
25 DKJ 1.5/16"	25	1"	16	33,30	1.5/16" - 12	34
25 DKJ 1.5/8"	25	1"	16	41,22	1.5/8" - 12	42
32 DKJ 1.5/8"	32	1.1/4"	20	41,22	1.5/8" - 12	42
32 DKJ 1.7/8"	32	1.1/4"	20	47,57	1.7/8" - 12	50
40 DKJ 1.7/8"	40	1.1/2"	24	47,57	1.7/8" - 12	50
50 DKJ 2.1/2"	50	2"	32	63,45	2.1/2" - 12	65